

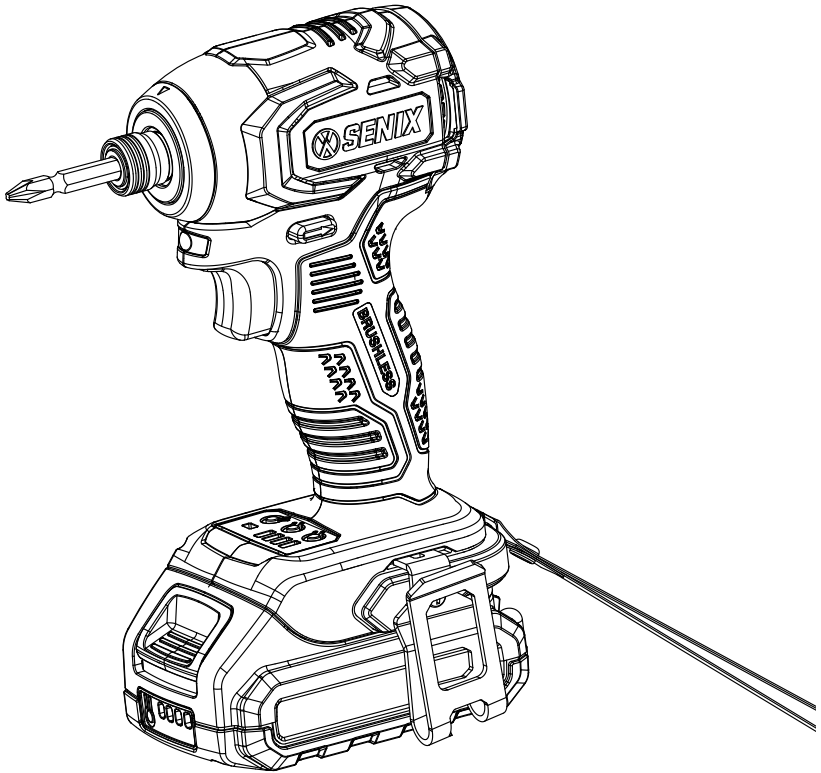

---

## 20V MAX LITHIUM ION IMPACT DRIVER

Model: PDIX2-M2-EU  
PDIX2-M2-EU-0



For customer service please find all information on [www.senixtools.com](http://www.senixtools.com)  
CAUTION: BEFORE USING THIS PRODUCT, READ THIS MANUAL AND  
FOLLOW ALL ITS SAFETY RULES AND OPERATING INSTRUCTIONS.

ORIGINAL INSTRUCTIONS

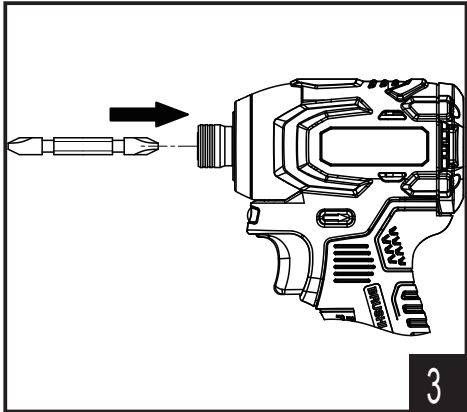
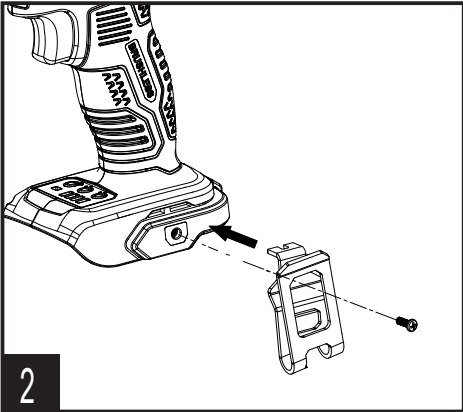
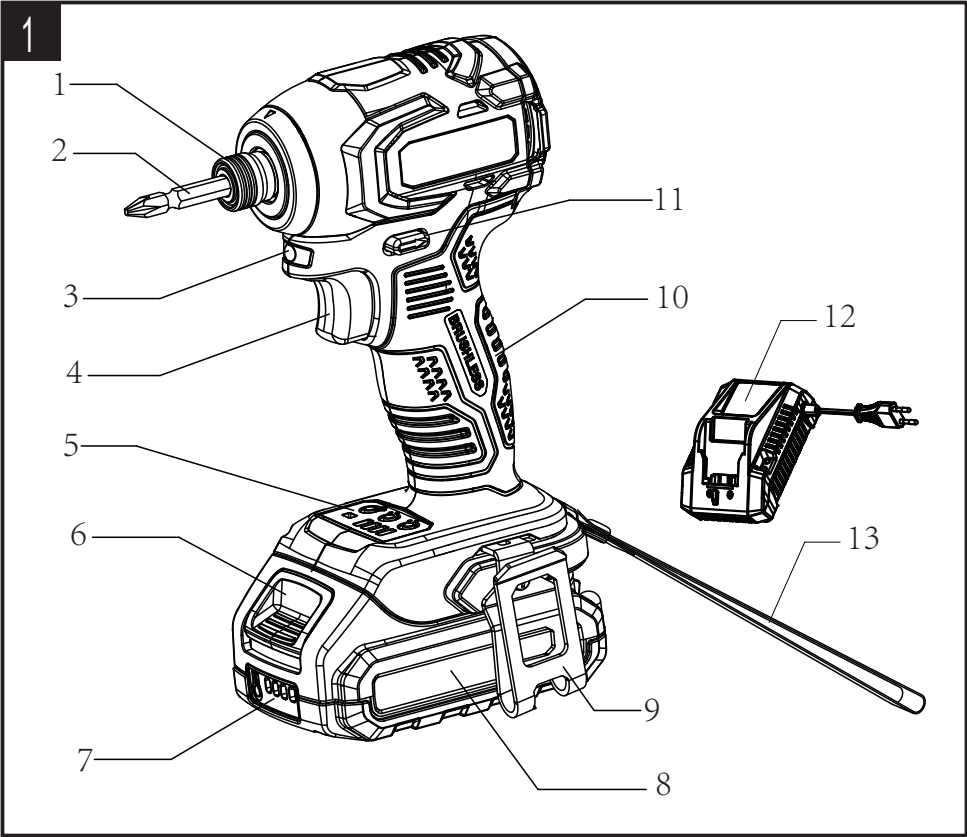

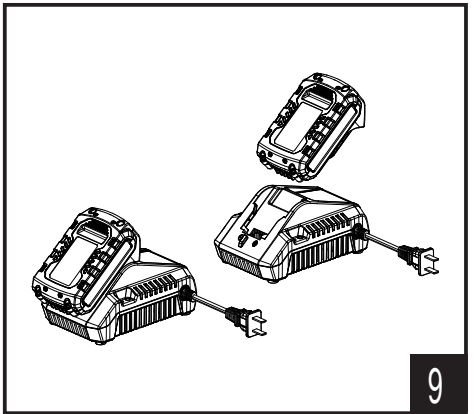
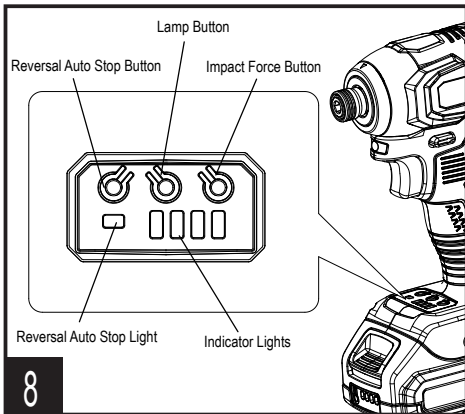
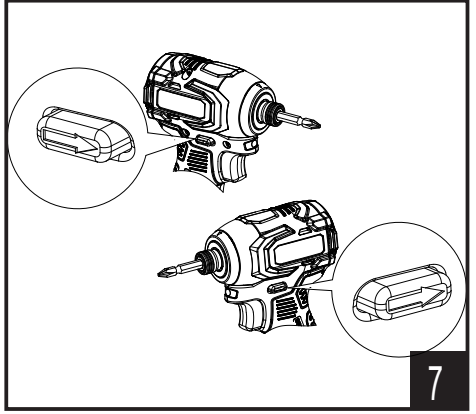
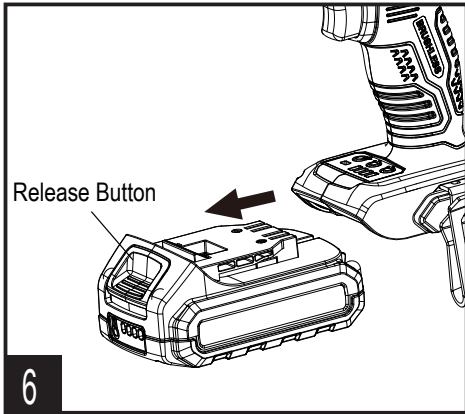
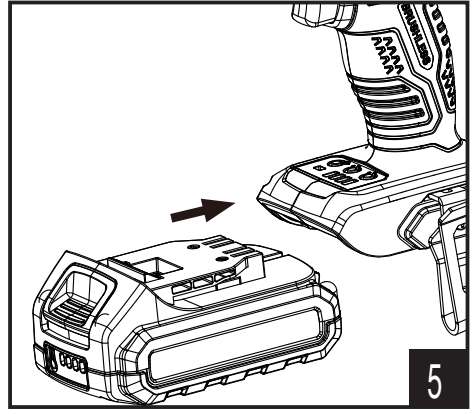
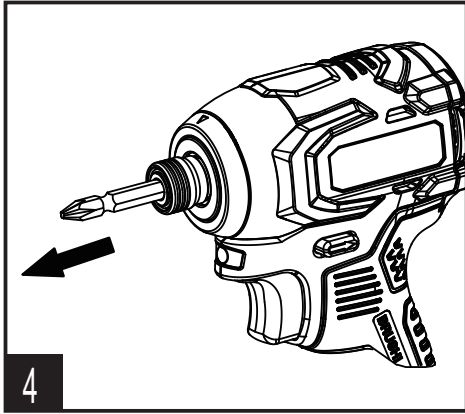

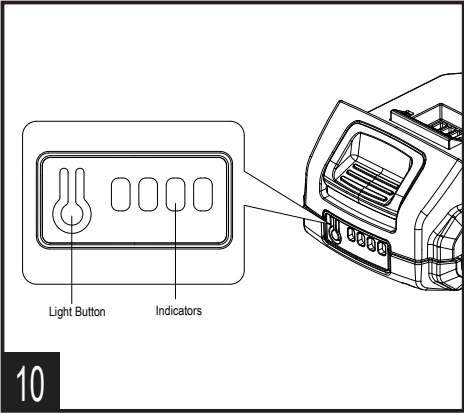

10

# TABLE OF CONTENTS

SAFETY & INTERNATIONAL SYMBOLS .....	5
SAFETY INSTRUCTIONS.....	6
KNOW YOUR UNIT.....	13
SPECIFICATIONS*.....	13
ASSEMBLY.....	13
OPERATION.....	14
MAINTENANCE.....	17
TROUBLESHOOTING.....	18
RECYCLING AND DISPOSAL.....	18
PARTS.....	19

# SAFETY & INTERNATIONAL SYMBOLS

Explanation of Safety & international symbols describes safety and international symbols and pictographs that may appear on this product. Read the operator's manual for complete safety, assembly, operating and maintenance and repair information.



Caution / Warning.



To reduce the risk of injury, user must read instruction manual.



Always wear ear protection.



Wear protective gloves.



Always wear eye protection.



Wear a dust mask.



Switch the product off and remove the battery pack to disconnect from the power supply before assembly, cleaning, adjustments, maintenance, storage and transportation.

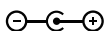

Polarity symbol of charger jack output +/-



Do not dispose of battery packs in rivers or immerse in water.



Do not dispose of battery packs in fire. They will explode and cause injury.



Use and store the battery within a temperature below 50°C.



Do not disassemble, crush, heat above 100°C ; Never expose the battery to microwaves or high pressures.



This charger is of protection class II. That means it is equipped with enhanced or double insulation.



The product complies with the applicable European directives and an evaluation method of conformity for these directives was done.



WEEE symbol. Waste electrical products should not be disposed of with household waste. Please recycle where facilities exist. Check with your Local Authority or local store for recycling advice.



Crossed out dust bin. Batteries and battery packs should not be disposed of with household waste. Please recycle where facilities exist. Check with your Local Authority or local store for recycling advice.

# SAFETY INSTRUCTIONS

## GENERAL POWER TOOL SAFETY WARNINGS

### WARNING!

Read all safety warnings, instructions, illustrations and specifications, provided with this power tool. Failure to follow all instructions listed below may result in electric shock, fire and/or serious injury.

Save all warnings and instructions for future reference.

The term "power tool" in the warnings refers to your mains-operated (corded) power tool or battery-operated (cordless) power tool.

### 1) Work Area Safety

- a) Keep work area clean and well lit. Cluttered or dark areas invite accidents.
- b) Do not operate power tools in explosive atmospheres, such as in the presence of flammable liquids, gases or dust. Power tools create sparks which may ignite the dust or fumes.
- c) Keep children and bystanders away while operating a power tool. Distractions can cause you to lose control.

### 2) Electrical Safety

- a) Power tool plugs must match the outlet. Never modify the plug in any way. Do not use any adapter plugs with earthed (grounded) power tools. Unmodified plugs and matching outlets will reduce risk of electric shock.
- b) Avoid body contact with earthed or grounded surfaces, such as pipes, radiators, ranges and refrigerators. There is an increased risk of electric shock if your body is earthed or grounded.
- c) Do not expose power tools to rain or wet conditions. Water entering a power tool will increase the risk of electric shock.
- d) Do not abuse the cord. Never use the cord for carrying, pulling or unplugging the power tool. Keep cord away from heat, oil, sharp edges or moving parts. Damaged or entangled cords increase the risk of electric shock.
- e) When operating a power tool outdoors, use an extension cord suitable for outdoor use. Use of a cord suitable for outdoor use reduces the risk of electric shock.

- f) If operating a power tool in a damp location is unavoidable, use a residual current device (RCD) protected supply. Use of an RCD reduces the risk of electric shock.
- d) Remove any adjusting key or wrench before turning the power tool on. A wrench or a key left attached to a rotating part of the power tool may result in personal injury.

### **3) Personal Safety**

- a) Stay alert, watch what you are doing and use common sense when operating a power tool. Do not use a power tool while you are tired or under the influence of drugs, alcohol or medication. A moment of inattention while operating power tools may result in serious personal injury.
- b) Use personal protective equipment. Always wear eye protection. Protective equipment such as a dust mask, non-skid safety shoes, hard hat or hearing protection used for appropriate conditions will reduce personal injuries.
- c) Prevent unintentional starting. Ensure the switch is in the off-position before connecting to power source and/or battery pack, picking up or carrying the tool. Carrying power tools with your finger on the switch or energising power tools that have the switch on invites accidents.
- e) Do not overreach. Keep proper footing and balance at all times. This enables better control of the power tool in unexpected situations.
- f) Dress properly. Do not wear loose clothing or jewellery. Keep your hair and clothing away from moving parts. Loose clothes, jewellery or long hair can be caught in moving parts.
- g) If devices are provided for the connection of dust extraction and collection facilities, ensure these are connected and properly used. Use of dust collection can reduce dust-related hazards.
- h) Do not let familiarity gained from frequent use of tools allow you to become complacent and ignore tool safety principles. A careless action can cause severe injury within a fraction of a second.

### **4) Power Tool Use And Care**

- a) Do not force the power tool. Use

the correct power tool for your application. The correct power tool will do the job better and safer at the rate for which it was designed.

- b) Do not use the power tool if the switch does not turn it on and off. Any power tool that cannot be controlled with the switch is dangerous and must be repaired.
- c) Disconnect the plug from the power source and/or remove the battery pack, if detachable, from the power tool before making any adjustments, changing accessories, or storing power tools. Such preventive safety measures reduce the risk of starting the power tool accidentally.
- d) Store idle power tools out of the reach of children and do not allow persons unfamiliar with the power tool or these instructions to operate the power tool. Power tools are dangerous in the hands of untrained users.
- e) Maintain power tools and accessories. Check for misalignment or binding of moving parts, breakage of parts and any other condition that may affect the power tool's operation.

If damaged, have the power tool repaired before use. Many accidents are caused by poorly maintained power tools.

- f) Keep cutting tools sharp and clean. Properly maintained cutting tools with sharp cutting edges are less likely to bind and are easier to control.
- g) Use the power tool, accessories and tool bits etc. in accordance with these instructions, taking into account the working conditions and the work to be performed. Use of the power tool for operations different from those intended could result in a hazardous situation.
- h) Keep handles and grasping surfaces dry, clean and free from oil and grease. Slippery handles and grasping surfaces do not allow for safe handling and control of the tool in unexpected situations.

## **5) Battery Tool Use And Care**

- a) Recharge only with the charger specified by the manufacturer. A charger that is suitable for one type of battery pack may create a risk of fire when used with another battery pack.
- b) Use power tools only with



specifically designated battery packs. Use of any other battery packs may create a risk of injury and fire.

- c) When battery pack is not in use, keep it away from other metal objects, like paper clips, coins, keys, nails, screws or other small metal objects, that can make a connection from one terminal to another. Shorting the battery terminals together may cause burns or a fire.
- d) Under abusive conditions, liquid may be ejected from the battery; avoid contact. If contact accidentally occurs, flush with water. If liquid contacts eyes, additionally seek medical help. Liquid ejected from the battery may cause irritation or burns.
- e) Do not use a battery pack or tool that is damaged or modified. Damaged or modified batteries may exhibit unpredictable behaviour resulting in fire, explosion or risk of injury.
- f) Do not expose a battery pack or tool to fire or excessive temperature. Exposure to fire or temperature above 130 °C may cause explosion.
- g) Follow all charging instructions and do not charge the battery

pack or tool outside the temperature range specified in the instructions. Charging improperly or at temperatures outside the specified range may damage the battery and increase the risk of fire.

## **6) Service**

- a) Have your power tool serviced by a qualified repair person using only identical replacement parts. This will ensure that the safety of the power tool is maintained.
- b) Never service damaged battery packs. Service of battery packs should only be performed by the manufacturer or authorized service providers.

## **SAFETY WARNINGS FOR IMPACT DRIVER**

- a) Hold the power tool by insulated gripping surfaces, when performing an operation where the cutting accessory or fasteners may contact hidden wiring. Cutting accessory or fasteners contacting a "live" wire may make exposed metal parts of the power tool "live" and could give the operator an electric shock.

## **ADDITIONAL SAFETY INFORMATION**

- a) Wear ear protectors when impact driving. Exposure to noise can cause hearing loss.
- b) Secure the workpiece. A workpiece clamped with clamping devices or in a vice is held more secure than by hand.
- c) Always wait until the power tool has come to a complete stop before placing it down. The application tool can jam and cause you to lose control of the power tool.
- d) Switch the power tool off immediately if the application tool becomes blocked. Be prepared for high torque reactions which cause kickback. The application tool becomes blocked when it becomes jammed in the workpiece or when the power tool becomes overloaded.
- e) Use suitable detectors to determine if there are hidden supply lines or contact the local utility company for assistance. Contact with electric cables can cause fire and electric shock. Damaging gas lines can lead to explosion. Breaking water pipes causes property damage.
- f) Hold the power tool securely. When tightening and loosening screws be prepared for temporarily high torque reactions.
- g) In case of damage and improper use of the battery, vapours may be emitted. The battery can set alight or explode. Ensure the area is well ventilated and seek medical attention should you experience any adverse effects. The vapours may irritate the respiratory system.
- h) Do not open the battery. There is a risk of short-circuiting.
- i) The battery can be damaged by pointed objects such as nails or screwdrivers or by force applied externally. An internal short circuit may occur, causing the battery to burn, smoke, explode or overheat.
- j) Only use the battery with products from the manufacturer. This is the only way in which you can protect the battery against dangerous overload.

## **SAFETY WARNINGS FOR BATTERY PACK**

- a) Ensure the switch is in the off position before inserting battery pack. Inserting the battery pack

into machines that have the switch on can cause accidents.

- b) Use only original battery packs intended specifically for this machine. Use of any other battery packs may create a risk of injury and fire.
- c) Do not open the battery. Danger of short-circuiting.
- d) Protect the battery against heat (e. g., against continuous intense sunlight and fire) water and moisture. Danger of explosion.
- e) In case of damage and improper use of the battery, vapours may be emitted. Ventilate the area and seek medical help in case of complaints. The vapours can irritate the respiratory system.
- f) Use the battery pack only in conjunction with this product and/or product family. This measure alone protects the battery against dangerous overload.

## **SAFETY WARNINGS FOR BATTERY CHARGER**



Read all safety warnings and instructions before using the charger.



Only for indoor use!



Class II protection.

- a) This appliance can be used by children aged from 8 years and above and persons with reduced physical, sensory or mental capabilities or lack of experience and knowledge if they have been given supervision or instruction concerning use of the appliance in a safe way and understand the hazards involved. Children shall not play with the appliance. Cleaning and user maintenance shall not be made by children without supervision.
- b) If the supply cord is damaged, it must be replaced by the manufacturer, its service agent or similarly qualified persons in order to avoid a hazard.
- c) Only charge the battery pack as specified in this instruction manual. Do not charge non-rechargeable batteries.
- d) Charge the product indoors only.
- e) Protect the charger against moisture and wet conditions. There is a danger of electric shock.
- f) Do not cover the battery charger. Otherwise, the battery charger can overheat and no longer operate properly.

## **RESIDUAL RISKS**

Every power tool contains risks, even all relevant safety standards are fulfilled and the instruction manual provides you abundant information for safety working.

Residual risks could be for example:

- a) Touching of moving parts or attachment.
- b) Touching with hot power tool accessory.
- c) Injuries and damage to property due to broken attachments or the sudden impact of hidden objects during use.
- d) Danger of injury and property damage caused by flying objects or poor power tool accessories.
- e) Lung damage by inhalation of dust.

Safe working also depends on the familiarity of the operating personnel in dealing with the respective power tool! Corresponding machine knowledge as well as prudent behavior during work help to minimize existing residual risks.

## **INTENDED USE**

This cordless impact driver is intended for driving in or loosening screws and bolts. Do not use it for other purposes.

## KNOW YOUR UNIT

### APPLICATIONS

Model: PDIX2-M2-EU

As a cordless impact driver:

Driving in or loosening screws and bolts.

1	Sleeve
2	Bit
3	Lamp
4	Switch Trigger
5	Control Panel
6	Release Button
7	Capacity Indicator
8	Battery Pack
9	Belt Clip
10	Handle
11	Reversing Switch Lever
12	Charger
13	Nylon Strap

## SPECIFICATIONS\*



### NOTE:

PDIX2-M2-EU-0 does not include the battery pack and the charger.

Model	PDIX2-M2-EU
Rated voltage	18 V d.c.
Rated no load speed $n_0$	
Max impact mode	0 - 3,000/min
Hard impact mode	0 - 2,700/min
Medium impact mode	0 - 2,000/min
Soft impact mode	0 - 1,100/min
Reversal stop mode	0 - 3,000/min
Product size	115*77*189.5 mm
Fastening capacity: Machine screw	Ø 4mm - 8mm
Standard bolt	Ø 5mm - 16mm
High tensile bolt	Ø 5mm - 14mm
Max. torque	180N.m
Weight (without battery)	Approx. 0.92kg

<b>Battery pack model for option</b>	B20X2
Rated voltage	18V $\overline{=}$ , 20V Max.
Rated capacity	2.0Ah
Weight	Approx. 0.335kg
<b>Battery pack model for option</b>	B40X2
Rated voltage	18V $\overline{=}$ , 20V Max.
Rated capacity	4.0Ah
Weight	Approx. 0.65kg

<b>Charger model for option</b>	CHX2
Rated input	100-240V ~ 50/60Hz
Rated output	21V, 2A
Charging time (with 2.0 Ah battery)	75mins
Charging time (with 4.0 Ah battery)	140mins
Protection class	□ / II
Weight	Approx. 0.34kg
<b>Charger model for option</b>	CHQX2
Rated input	100-240V ~ 50/60Hz
Rated output	21V, 4A
Charging time (with 2.0 Ah battery)	35mins
Charging time (with 4.0 Ah battery)	70mins
Protection class	□ / II
Weight	Approx. 0.482kg
Optimal charging temperature	20°C–25°C.

## ASSEMBLY

1. Unpack all parts and lay them on a flat, stable surface:
2. Remove all packing materials and shipping devices, if applicable.
3. The scope of delivery varies depending on the country and purchased variant:

Model of PDIX2-M2-EU

- Power tool x1
  - Instruction manual x1
  - Screwdriver bit x1
  - Belt clip x1
  - Screw x1
  - Nylon Strap x1
  - Battery pack x1
  - Charger x1
4. If you find that parts are missing or show damage do not use the product but contact your dealer. Using an incomplete or damaged product represents a hazard to people and property.
5. Ensure that you have all the accessories and tools needed for assembly and operation. This also includes suitable personal protective equipment.



### NOTE:

PDIX2-M2-EU-0 does not include the battery pack and the charger.



### WARNING:



Wear protective gloves for this assembly work and always lay the product on a flat and stable surface while assembling.



Follow the assembly instructions step-by-step and use the pictures provided as a visual guide to easily assemble the product!

Do not insert the battery pack before the power tool is completely assembled or adjusted!

## ASSEMBLING THE BELT CLIP

The product can be attached to your belt with the belt clip, which can be assembled with a screw.

Assemble the belt clip on the right side of the handle for right-hander. For left-hander, please relocate it to the left side symmetrically (Fig. 2).

## ASSEMBLING DRIVER BIT



### WARNING:

Observe the technical requirements of this product (see section "SPECIFICATIONS") when purchasing and using application tools (e.g. adapter for wrench socket or screwdriver bits). Always use suitable application tool according to the intended use. For example, the dimension of screwdriver bit and screw shall match each other. Always hold the product firmly in the hand while assembling application tool.

To install:

Align the driver bit with the axle hole and insert the bit to the end. Make sure the bit is firmly fixed in case of accidents (Fig. 3).

To remove:

Pull the sleeve in the direction of the arrow at first. Then pull the driver bit out (Fig. 4).



### NOTE:

If the driver bit is not inserted deep enough into the sleeve, the driver bit will not be secured. In this case, try re-inserting again. After inserting the driver bit, make sure that it is firmly secured. If it comes out, do not use it.

## INSTALLING/REMOVING THE BATTERY PACK



### WARNING:

Make sure battery pack snaps in place. Failure to securely seat the battery pack could cause the battery pack to fall out, resulting in serious personal injury.

To install:

Align and slide the battery pack to the bottom of the power tool until it is locked in position (Fig. 5).

To remove:

Press the release button on battery pack and remove the battery pack from the product (Fig. 6).

## OPERATION

### SETTING ROTATIONAL DIRECTION

For achieving the aim of tightening or loosening bolt/nut, choose the desired mode by pushing the reversing switch lever (Fig. 7).

Mode	Setting	Application
Forward	Press the reversing switch lever on the right side to left.	Driving or tightening.
Backward	Press the reversing switch lever on the left side to right.	Loosening.

Locking	Shift the reversing switch lever to the center.	Switch trigger will be locked to avoid unintended switching on.
---------	---	---



## NOTE:

The reversing switch lever shall be set to "locking" position until other settings are done and before switching on the product. This will avoid unintended switching on.

## SETTING IMPACT FORCE

Press the impact force button to adjust the impact force. The four indicator lights on the control panel show the current selected impact force (Fig. 8). Find the details in the table below.

Mode	Pressing times	Status	Impact force
Forward	Once		Soft
	Twice		Medium
	Three times		Hard
	Four times		Max
Backward	Once		Soft
	Twice		Medium
	Three times		Hard
	Four times		Max



## NOTE:

The unit will keep the same impact force according to last operation after restarting or re-installing the battery.

## REVERSAL AUTO STOP MODE

This mode helps to prevent a bolt from falling off. When loosening a bolt with the tool driving in backward rotation,

the tool automatically stops after the bolt/nut gets enough loosened. The stroke of the switch trigger to reach maximum speed will become short in this mode. The light of the reversal auto stop mode turns green after pressing the reversal auto stop button (Fig. 8).



## NOTE:

The reversal auto stop mode can only be used under the backward mode.

## SWITCH TRIGGER

1. Press the switch trigger and hold it in position to switch on the power tool.
2. The rotation speed and output power of the power tool depend on the pressing depth of the switch trigger.
3. Release the switch trigger to switch off the power tool.

## LAMP

The driver is designed with a lamp for lighting the area near the drill or screw driving bit.

Press the lamp button of the control panel to turn on the lamp. Press again to turn off the lamp (Fig. 8).

## HOW TO CHARGE THE BATTERY PACK



## WARNING:









This Lithium-Ion battery pack is shipped partially charged. Fully charge the battery pack before using it for the first time.

1. Charge the Lithium-Ion battery pack only with the correct charger.
2. Connect the charger to a power supply, the light indicator of the charger turns red.
3. Align the raised ribs of the battery pack with the slot in the charger.
4. Insert the battery pack into the charger, the light indicator of the charger turns green and it flashes.
5. The charger will communicate with the battery pack to evaluate the condition of the battery pack.
6. It is fully charged that the four lights of the battery turn on. Disconnect the power supply from the charger. Remove battery pack from the charger (Fig. 9).

## CHARGING INDICATOR

Press the light button on the battery pack to check the

battery pack whether needs to charge. Four indicators on the battery can tell the current battery capacity (Fig. 10).

Lights			Status
Lighted	Off	Blinking	
			
			The battery is at full capacity.
			The battery is at 75% capacity.
			The battery is at 50% capacity and requires charging.
			The battery is at 25% capacity and requires charging soon.
			The battery is less than 5% capacity and requires charging immediately.



## WARNING:

Malfunctions may occur when the four lights blinking in turns.

## OVERHEAT PROTECTION

When the tool/battery is overheated, the tool stops automatically. In this situation, let the power tool/battery cool before turning the tool on again.

## OVERDISCHARGE PROTECTION

When the battery capacity is not enough, the tool stops automatically. In this case, remove the battery from the tool and charge the battery.

## PRACTICAL ADVICES

### 1) General

1. The torque depends on the impact duration. The maximum achieved torque results from the sum of all individual torques achieved through impact. Maximum torque is achieved after an impact duration of 6–10 seconds. After this duration, the tightening torque is increased only minimally.
2. The impact duration is to be determined for each required tightening torque. The actually achieved tightening torque is always to be checked with a torque wrench.
3. Ensure that correct application tool is fitted and all controls are set in correction position.
4. Always hold the product perpendicular to the workpiece. Holding it at an angle may cause slipping, jamming or damage of application tool, screw/bolt and workpiece.
5. Always place the application tool in position first and then switch the product on.
6. Apply proper feeding force to keep the connect of bit/socket and screw/bolt/nut. Too big feeding force will not increase working effectiveness but increase the risk of loss of control and heating of screw/bolt.
7. If the screw/bolt gets stuck in the workpiece, switch the power tool off, switch to reverse rotation mode and press the switch trigger slightly to loosen the screw/bolt.
8. Check the application tool regularly during work. Refit or replace it if necessary.

### 2) Driving Wood Screws

1. Before screwing larger, longer screws into hard materials, it is advisable to pre-drill a pilot hole with the core diameter of the thread to the entire screw length.
2. Hold the power tool perpendicular to the screw head and keep the driver bit tip well inserted in the screw head.
3. Ensure enough pressure so that the driver bit tip will always stay in the screw head and then switch the product on.
4. Start with low speed until the screw penetrates workpiece perpendicularly.

### 3) Driving Machine Screws/Bolts/Nuts

1. Please pay attention to the guide values for maximum screw tightening torques (e.g. DIN 267), in order to avoid damages caused by overtightening. As a control measure, always check the tightening torque with a torque wrench.
2. A hard seat is a metal-to-metal driving application which uses washers. After a relatively short impact duration, the maximum torque is reached. Unnecessary long impact duration only causes damage to the parts and workpiece.
3. A spring-loaded seat is also a metal-to-metal driving application but uses spring washers, disc springs, studs



or screws/nuts with conical seats. For a spring-loaded seat as well as for a soft seat, the maximum tightening torque is lower than for a hard seat. Also, a clearly longer impact duration is required.

4. Start with low speed until the screw/bolt/nut is fitted along the thread properly.



## WARNING:

Do not use the power tool like a hand screw driver or wrench, this could damage the automatic spindle lock in the power tool.

## AFTER USE

1. Switch the product off, wait for a complete stop, switch the reversing switch lever to middle position, remove the battery pack, let the power tool and battery pack cool down and remove the application tool.
2. Check, clean, maintain and store the product as described below.

## MAINTENANCE



## WARNING:



Always switch the product off, remove the battery pack and let the product cool down before performing cleaning and maintenance work!

Only perform cleaning and maintenance work according to these instructions! All further works must be performed by a qualified specialist!

## CLEANING

1. Clean the product with a dry cloth. Use a brush for areas that are hard to reach.
2. In particular clean the chuck, switches and air vents after every use with a cloth and brush.
3. Remove stubborn dirt with high pressure air (max. 3 bar).
4. Check for worn or damaged parts. Replace worn parts as necessary or contact an authorised service centre for repair before using the product again.



## NOTE:

Do not use chemical, alkaline, abrasive or other aggressive detergents or disinfectants to clean this product as they might be harmful to its surfaces.

## MAINTENANCE

Your power tool requires no additional lubrication or maintenance.

There are no user serviceable parts in your power tool.

Before and after each use, check the product and accessories (or attachments) for wear and damage. If required, exchange them for new ones as described in this instruction manual.

## TRANSPORT

1. Cleaning the product and keep the battery pack removed.
2. Remove the application tool.
3. Protect the product from any heavy impact or strong vibrations which may occur during transportation in vehicles.
4. Secure the product to prevent it from slipping or falling over.

## STORAGE

1. Cleaning the product and keep the battery pack removed.
2. Check and charging the battery pack before long-term storage. Repeat this step at least every 6 months.
3. Store the product and its accessories in a dark, dry, frost-free and well-ventilated place.
4. Always store the product in a place that is inaccessible to children. The ideal storage temperature is between 10°C and 30°C.
5. We recommend using the original package for storage or covering the product with a suitable cloth or enclosure to protect it against dust.

## TROUBLESHOOTING

Suspected malfunctions are often due to causes that the users can fix themselves. Therefore, check the product using this section. In most cases the problem can be solved quickly.

PROBLEM	POSSIBLE CAUSE	SOLUTION
Product does not start	Reversing switch lever at centre locking position	Reversing switch lever to proper side
	Battery pack not properly attached	Attach properly
	Battery pack discharged	Charge the battery pack
Product does not reach full power	Battery pack capacity too low	Charge the battery pack
	Battery pack reaches its life cycle	Replace with new battery pack
Unsatisfactory result	Drill/driver bit is dull/damaged	Replace with new one
	Driver bit / socket bit not suitable for intended operation	Use proper one

## RECYCLING AND DISPOSAL



Disposal of waste electric and electronic equipment (WEEE)

Waste electric and electronic equipment shall not be disposed of with household waste. Please recycle where facilities exist. Check with your local authority for recycling advice.



Disposal of defective or used battery pack  
 Discharge your battery pack by operating your tool, then remove the battery pack from the tool. Cover the battery pack connections with heavy duty adhesive tape to prevent short circuit and energy discharge.  
 Do not attempt to open or remove any of the components.  
 Batteries and battery packs shall not be disposed of with household waste. Consult your local waste authority for information regarding available recycling and/or disposal options.

# PARTS

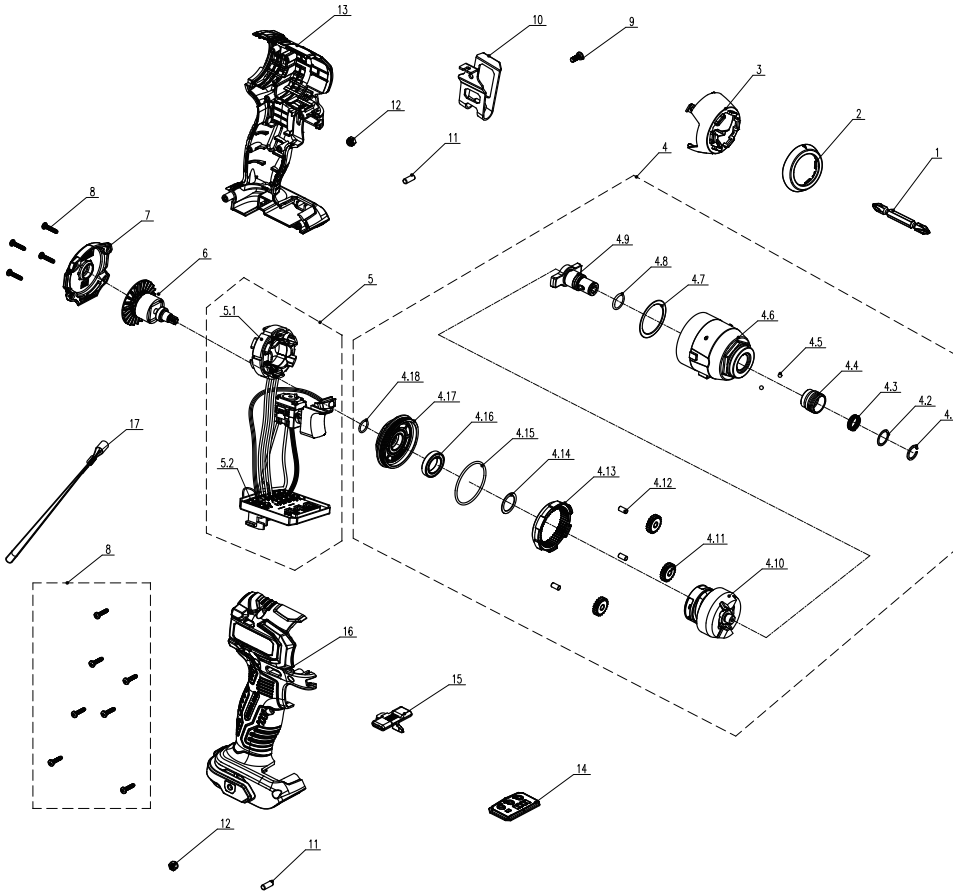

No.	Part #	Description	Qty.
1	B048023-015-00	Driver bit	1
2	B047030-007-00	Driver head cap	1
3	B048019-022-00	Driver head cover	1
4	B048023-004-00	Driver head assembly	1
4.1	B048009-004-00	Retaining ring	1
4.2	B048019-028-00	Flat plate	1

4.3	B048019-056-00	Compression spring	1
4.4	B048019-009-00	Sleeve for bit holder	1
4.5	8DQ-3.5	Steel ball	2
4.6	B048019-004-00	Driver head cover	1
4.7	B047030-004-00	Flat washer	1
4.8	B048019-008-00	Ring	1
4.9	B048019-007-00	Shaft	1
4.10	B048023-005-00	Impact model assembly	1
4.11	B048019-012-00	Gear	3
4.12	B048019-013-00	Cylindrical rod	3
4.13	B048019-018-00	Annular gear	1
4.14	B048019-017-00	Flat washer	1
4.15	B048019-019-00	Ring	1
4.16	B048016-029-00	Deep groove ball bearing	1
4.17	B048019-020-00	Cover	1
4.18	B048002-021-00	Sealing ring	1
5	B048023-008-00	Motor assembly	1
5.1	B048023-011-00	Stator component	1
5.2	B048023-013-00	Electronic component	1
6	B048023-012-00	Rotor component	1
7	B048019-032-00	End cover	1
8	8SJEB30-14	Hexalobular socket pan head self tapping screw	11
9	8SJAD04-10	Crossing recessed pan head screw	1
10	B048023-014-00	Belt clip	1
11	B048019-034-00	Rubber rod	2
12	8NH-04B	Type I hex screw with non-metallic insret	2
13	B048023-002-00	Left cabinet	1
14	B048019-030-00	Control Ppnel	1
15	B048019-026-00	Reversing switch lever	1
16	B048023-003-00	Right cabinet	1
17	B048019-033-00	Nylon Strap	1